

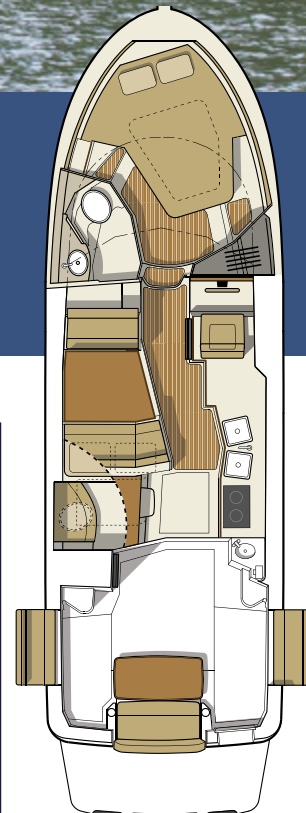

# R-31 CB



**The R-31 CB is the largest of the trailerable Ranger Tugs**, making her ideal for extended cruising while offering ample space for guests. The tall vantage and additional entertaining area added with the inclusion of the Command Bridge brings an entirely new perspective to cruising. It is equipped with electronic controls at both the upper and lower helm stations and the spacious bridge has a table and room to seat six. The command bridge also retracts to allow for trailering. She comes standard with bow and stern thrusters for ease of handling. The foredeck features seating and a table that can be raised for entertaining and lowered while underway. The generous cockpit also features wraparound seating utilizing hidden seats that fold out of the gunwale. The interior layout of the R-31 CB features two staterooms - one large island berth forward with en suite head and a midship berth with day head. A starboard side door provides easy access from the lower helm to the side decks for line handling. Like all Ranger Tugs, the R-31 CB comes turn-key with standard features and equipment intended to make her owner's experience hassle-free and allow for ease of handling and comfort under way.



## Specifications

Length LOH	31' 2"	9.5 m
Length LOA (rigged w/swimstep)	34' 10"	10.6 m
Beam	10'	3.1 m
Draft	30"	0.76 m
Bridge clearance (bridge/mast up)	18' 2"	5.53 m
Bridge clearance (bridge/mast down)	10' 3"	3.12 m
Height on factory trailer (bridge/mast down)	13' 4"	4.06 m
Length on factory trailer	41' 0"	12.50 m
Fuel capacity	180 US Gal	681 L
Water capacity	60 US Gal	227.1 L
Hot water	11 US Gal	41.6 L
Holding tank capacity	40 US Gal	151.4 L
Weight, Dry	12,500 lbs	5,670 kg
Engine	Volvo D4 320 HP diesel common rail electronic engine	





## Standard Features

### Performance

320 HP Volvo D4 inboard  
**Electric trim tabs**  
**Thruster, bow**  
**Thruster, stern**  
**Thruster, wireless remote**  
 Trailerable - 10' beam

### Accommodations & Interior Comfort

Cabin Drink holders, 4  
 Cabin heater (engine)  
 Curtains for privacy  
 Dinette converts to bed  
**Electric toilet**  
**Fully enclosed head**  
**Fusion stereo system (multi-zone)**  
 Hatches, pilothouse roof, solar reflective, 4  
 Hatches, stateroom, 1  
 Indirect cabin lighting  
**Island bed**  
**LED lighting**  
**Marine head w/ holding tank**  
**Memory foam mattress**  
 Opening portlights, 2  
 Private stateroom  
 Second berth or stateroom  
 Shower with enclosure  
 Storage under mattress  
**Transom entry door for boarding**  
**TV/DVD in salon**  
**TV/DVD in stateroom**

### Deck Features

**Anchor package, 22 lb, 50' chain, 200' line**  
 Bow lounge seating, 2  
 Folding stainless steel mast for trailering  
 Forward line storage  
**Rod holders, 2**  
**Sport racks**  
 Stainless steel swimming ladder  
**Swim step with built-in fenders**  
**Washdown system**  
**Windlass**

### Cockpit

**Cockpit cover, hard-top**  
 Cabin drink holders, 5  
 Cockpit hardtop w/ hatches  
 Cockpit hardtop w/ lights  
**Cockpit refrigerator**  
 Cockpit seating, 6  
**Cockpit sink**  
 Cockpit table  
 Fold-out cockpit seating  
 Fold-out gunwale seating  
**Powered engine hatch**



### Helm

**AIS receiving**  
**Autopilot**  
**Color engine display**

### Digital fuel flow data

Drink holder  
**Electronic shift and throttle control, single lever**  
**Garmin navigation system w/ GPS and sonar, 8612xsv**  
**Garmin radar, xHD**  
 Helm door  
 Helm seat, double  
**Windshield wipers, 4**



### Galley

Cutting board  
 Galley cabinets, 4  
 Galley drawers, 4  
**Microwave**  
 Offset galley for clear walkway  
**Oven, propane**  
 Pull-out rinse faucet  
**Refrigerator/freezer**  
**Sink with hot and cold water, double basin**  
**Stove top, propane**  
**Wine/water cooler**

### Mechanical & Electrical

AC electrical panel  
**Batteries**  
**Battery charger**  
 DC electrical panel  
**Inverter**  
**Macerator discharge**  
 Sea water strainers  
 Shore power cords  
**Solar panel w/ control panel**  
**Sonar**  
**Underwater lights**

### Command Bridge

Command bridge table  
 Drink holders, 2  
**Garmin navigation system, 8612**  
 Seating, 6

### RANGER TUGS = MORE VALUE

**Bolded items:** High value features included in the price of the Ranger Tugs R-31 CB. Other manufacturers oftentimes list these features as options with an additional cost.



### Safety

Carbon monoxide detectors  
 Courtesy lights  
 Electric horn  
 Illuminated compass  
 Navigation lights  
**ReFlex high density closed cell foam decking**  
**Safety kit: fenders, lines, flares, fire ext, first aid kit, life jackets, boat hook**  
**Spotlight with remote**  
**Swim platform rails**  
**VHF radio, DSC capable**  
 Window defrosters

### Construction

Bonded electrical system  
 Foam-filled fiberglass stringer grid system  
**Premium hull color, Midnight Blue**  
 Self bailing cockpit  
 Stainless steel cleats, rails, hardware  
 Vinylster barrier coat

## Ranger Tugs R-31 CB Packages - FACTORY DIRECT PRICING

The Ranger Tugs R-31 CB is sold **fully equipped** and **ready to cruise** with an expansive selection of premium features and outfitted in one of two packages:

**Northwest Edition:** Most commonly used in colder climates where air conditioning would not be needed or necessary. **Equipped with diesel heater & forced air furnace, and downrigger plugs and pads.**

**NORTHWEST EDITION, FULLY EQUIPPED FROM: \$399,937.00\***

**Luxury Edition:** Most commonly used in warmer climates where air conditioning is a must. **Equipped with air conditioning/reverse cycle heating, and diesel generator w/ sound shield.**

**LUXURY EDITION, FULLY EQUIPPED FROM: \$414,937.00\***

### Additional Factory Options

Aft cockpit sun and sunset shades	\$1,575
Aft steering, second station with electronic controls	\$5,220
Aluminum triple axle trailer, electric/hydraulic brakes, spare tire w/bracket	\$16,490
Bimini top, command bridge, helm seating only	\$3,610
Carpet runner, Teak and Holly, cockpit	\$755
Carpet runner, Teak and Holly, interior	\$650
Cockpit freezer (in lieu of cockpit refrigerator)	\$630
Cockpit ice maker (in lieu of cockpit refrigerator)	\$630
Dinghy, inflatable RIB 290 CSM hypalon with Weaver davits, stand-off & winch	\$6,065
Factory Delivery Experience	\$3,150
Garmin Weather Antenna	\$1,575
Low speed module	\$2,100
Volvo Five Year Extended Coverage	\$3,360
Hull color upgrade (from standard Midnight Blue)	\$7,875

\*Options, freight & taxes extra. Prices, specifications, equipment and options may change without notice. Information on this sheet should not be used for navigation. 0821



47 37th st NE  
 Auburn, WA, 98002  
 Phone: 253-839-5213

[www.RangerTugs.com](http://www.RangerTugs.com)

