

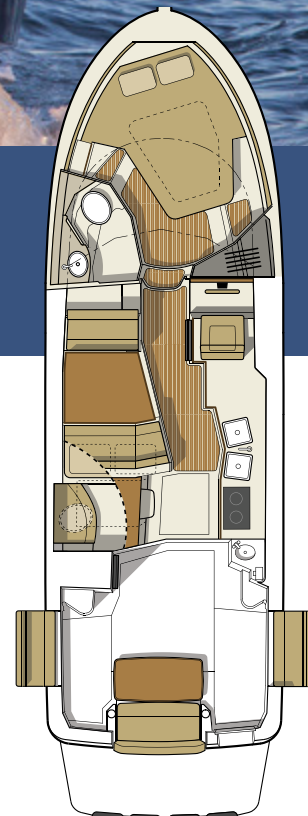

R-31 S



The R-31 S is the largest of the trailerable Ranger Tugs, making her ideal for extended cruising and entertaining. She comes standard with bow and stern thrusters for ease of handling. The foredeck features seating and a table that can be raised for entertaining and lowered while underway. The generous cockpit also features wraparound seating utilizing hidden seats that fold out of the gunwale. The interior layout of the R-31 S features two staterooms - one large island berth forward with en suite head and a midship berth with day head. A starboard side door provides easy access from the helm to the side decks for line handling. Like all Ranger Tugs, the R-31 S comes turn-key with standard features and equipment intended to make her owner's experience hassle-free and allow for ease of handling and comfort under way



Specifications

Length LOH	31'	9.44 m
Length LOA (rigged w/swimstep)	34' 10"	10.6 m
Beam	10'	3.05 m
Draft	30"	0.76 m
Bridge clearance (mast up)	13' 10"	4.21 m
Bridge clearance (mast down)	10'	3.1 m
Height on factory trailer	13' 6"	4.11 m
Length on factory trailer	41' 0"	12.50 m
Fuel capacity	180 US Gal	681 L
Water capacity	60 US Gal	227.1 L
Hot water	11 US Gal	41.6 L
Holding tank capacity	40 US Gal	151.4 L
Weight, Dry	12,000 lbs	5,443 kg
Engine	Volvo D4 320 HP diesel common rail electronic engine	



Standard Features

Performance

320 HP Volvo D4 inboard
Electric trim tabs
Thruster, bow
Thruster, stern
Thruster, wireless remote
 Trailerable - 10' beam

Accommodations & Interior Comfort

Cabin Drink holders, 4
 Cabin heater (engine)
 Curtains for privacy
 Dinette converts to bed
Electric toilet
Fully enclosed head
Fusion stereo system (multi-zone)
 Hatches, pilothouse roof, solar reflective, 4
 Hatches, stateroom, 1
 Indirect cabin lighting
Island bed
LED lighting
Marine head w/ holding tank
Memory foam mattress
 Opening portlights, 2
 Private stateroom
 Second berth or stateroom
 Shower with enclosure
 Storage under mattress
Transom entry door for boarding
TV/DVD in salon
TV/DVD in stateroom



Deck Features

Anchor package, 22 lb, 50' chain, 200' line
 Bow lounge seating, 2
 Forward line storage
Rod holders, 2
Sport racks
 Stainless steel swimming ladder
Swim step with built-in fenders
Washdown system
Windlass

Cockpit

Cockpit cover, hard-top
 Cabin drink holders, 5
 Cockpit hardtop w/ hatches
 Cockpit hardtop w/ lights
Cockpit refrigerator
 Cockpit seating, 6
Cockpit sink
 Cockpit table
 Fold-out cockpit seating
 Fold-out gunwale seating
Powered engine hatch



Helm

AIS receiving
Autopilot

Color engine display
Digital fuel flow data
 Drink holder
Electronic shift and throttle control, single lever
Garmin navigation system w/ GPS and sonar, 8612xsv
Garmin radar, xHD
 Helm door
 Helm seat, double
Windshield wipers, 4



Galley

Cutting board
 Galley cabinets, 4
 Galley drawers, 4
Microwave
 Offset galley for clear walkway
Oven, propane
 Pull-out rinse faucet
Refrigerator/freezer
Sink with hot and cold water, double basin
Stove top, propane
Wine/water cooler

Mechanical & Electrical

AC electrical panel
Batteries
Battery charger
 DC electrical panel
Inverter
Macerator discharge
 Sea water strainers
 Shore power cords
Solar panel w/ control panel
Sonar
Underwater lights

Safety

Carbon monoxide detectors
 Courtesy lights
 Electric horn
 Illuminated compass
 Navigation lights
ReFlex high density closed cell foam decking
Safety kit: fenders, lines, flares, fire ext, first aid kit, life jackets, boat hook
Spotlight with remote
Swim platform rails
VHF radio, DSC capable
 Window defrosters

Construction

Bonded electrical system
 Foam-filled fiberglass stringer grid system
Premium hull color, Midnight Blue
 Self bailing cockpit
 Stainless steel cleats, rails, hardware
 Vinylester barrier coat.

RANGER TUGS = MORE VALUE

Bolded items: High value features included in the price of the Ranger Tugs R-31 S. Other manufacturers oftentimes list these features as options with an additional cost.

Ranger Tugs R-31 S Packages - FACTORY DIRECT PRICING

The Ranger Tugs R-31 S is sold **fully equipped** and **ready to cruise** with an expansive selection of premium features and outfitted in one of two packages:

Northwest Edition: Most commonly used in colder climates where air conditioning would not be needed or necessary. **Equipped with diesel heater & forced air furnace, and downrigger plugs and pads.**

NORTHWEST EDITION, FULLY EQUIPPED FROM: \$374,937.00*

Luxury Edition: Most commonly used in warmer climates where air conditioning is a must. **Equipped with air conditioning/reverse cycle heating, and diesel generator w/ sound shield.**

LUXURY EDITION, FULLY EQUIPPED FROM: \$389,937.00*

Additional Factory Options

Aft cockpit sun and sunset shades	\$1,575
Aft steering, second station with electronic controls	\$5,220
Aluminum triple axle trailer, electric/hydraulic brakes, spare tire w/bracket	\$16,490
Carpet runner, Teak and Holly, cockpit	\$755
Carpet runner, Teak and Holly, interior	\$650
Cockpit freezer (in lieu of cockpit refrigerator)	\$630
Cockpit ice maker (in lieu of cockpit refrigerator)	\$630
Dinghy, inflatable RIB 290 CSM hypalon with Weaver davits, stand-off & winch	\$6,065
Factory Delivery Experience	\$3,150
Garmin Weather Antenna	\$1,575
Low speed module	\$2,100
Volvo Five Year Extended Coverage	\$3,360
Hull color upgrade (from standard Midnight Blue)	\$7,875

*Options, freight & taxes extra. Prices, specifications, equipment and options may change without notice. Information on this sheet should not be used for navigation. 0821



47 37th st NE
 Auburn, WA, 98002
 Phone: 253-839-5213

www.RangerTugs.com

