



R-31 CB



The R-31 Command Bridge is the largest of the trailerable Ranger Tugs, making her ideal for extended cruising while offering ample space for guests. The tall vantage and additional entertaining area added with the inclusion of the Command Bridge brings an entirely new perspective to cruising. It is equipped with electronic controls at both the upper and lower helm stations and the spacious bridge has a table and room to seat six. The command bridge also retracts to allow for trailering. She comes standard with bow and stern thrusters for ease of handling. The foredeck features seating and a table that can be raised for entertaining and lowered while underway. The generous cockpit also features wraparound seating utilizing hidden seats that fold out of the gunwale. The interior layout of the R-31 CB features two staterooms - one large island berth forward with en suite head and a midship berth with day head. A starboard side door provides easy access from the lower helm to the side decks for line handling. Like all Ranger Tugs, the R-31 CB comes turn-key with standard features and equipment intended to make her owner's experience hassle-free and allow for ease of handling and comfort under way.

Specifications

Length LOH	31'	9.44 m
Length LOA (rigged w/swimstep)	34' 10"	10.6 m
Beam	10'	3.1 m
Draft	30"	0.76 m
Bridge clearance (bridge/mast up)	18' 2"	5.53 m
Bridge clearance (bridge/mast down)	10' 3"	3.12 m
Height on factory trailer (bridge/mast down)	13' 4"	4.06 m
Length on factory trailer	41' 0"	12.50 m
Fuel capacity	180 US Gal	681 L
Water capacity	60 US Gal	227.1 L
Hot water	11 US Gal	41.6 L
Holding tank capacity	40 US Gal	151.4 L
Weight, Dry	12,500 lbs	5,670 kg
Engine	Volvo D4 320 HP diesel common rail diesel engine	

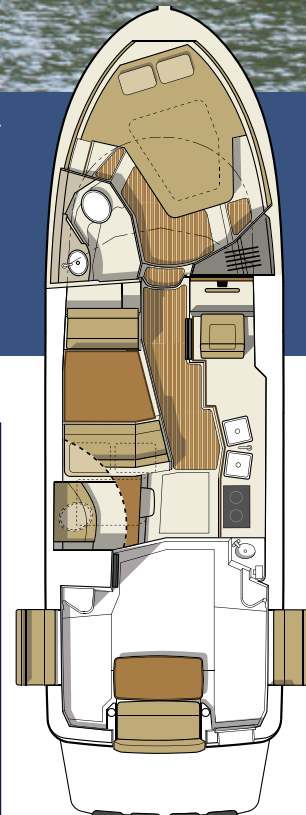

Standard Features

Performance

320 HP Volvo D4 diesel inboard
Electric trim tabs
Bow and stern thrusters
Thruster wireless remote
 Trailerable - 10' beam

Accommodations & Interior Comfort

Cabin Drink holders, 4
 Cabin heater (engine)
 Curtains for privacy
 Dinette (seats 5) converts to bed
Fully enclosed head
Fusion stereo system (multi-zone)
 Hatches, pilothouse roof, solar reflective, 4
 Hatches, stateroom, 1
 Indirect cabin lighting
Island bed
LED lighting
Electric marine toilet w/ holding tank
Memory foam mattress
 Midship stateroom
 Opening portlights, 2
 Private forward stateroom
 Shower with enclosure
 Storage under mattress
TV/DVD in salon
TV/DVD in stateroom



Deck Features

Anchor package, 22 lb, 50' chain, 200' line
 Bow lounge seating, 2
 Folding stainless steel mast for trailering
 Forward line storage
ReFlex high density closed cell foam decking
Rod holders, 2
Sport racks, stainless steel
 Swimming ladder, stainless steel
Swim step, with built-in fenders
Washdown system
Windlass, bow and helm controls

Cockpit

Cockpit cover, hard-top w/ hatches and lights
 Cabin drink holders, 5
Cockpit refrigerator
 Cockpit seating, 6+
Cockpit sink
 Cockpit table
 Fold-out gunwale seating
Powered engine hatch
Transom entry door for boarding



Helm

AIS receiving
Color engine display
Digital fuel flow data
Electronic shift and throttle control, single lever
Garmin autopilot
Garmin navigation system w/ GPS and sonar, 8612xsv

Garmin radar, xHD
 Helm door
 Helm drink holder
Windshield wipers, 4

Galley

Cutting board
 Galley cabinets, 4
 Galley drawers, 4
Microwave
 Offset galley for clear walkway
Oven, propane
Refrigerator/freezer
Sink with hot and cold water, double basin, with pull-out rinse faucet
Stove top, propane
Wine/water cooler

Mechanical & Electrical

AC electrical panel
Batteries
Battery charger
 DC electrical panel
Inverter
Macerator discharge
 Seawater strainers
 Shore power cord(s)
Solar panel w/ controller
Underwater lights

Command Bridge

Command bridge
 drink holders, 2
Full helm controls
Garmin navigation system, 8612
 Removable command
 bridge table
 Seating, 6

Safety

Carbon monoxide detectors
 Courtesy lights
 Electric horn
 Illuminated compass
 Navigation lights
Safety kit: fenders, lines, flares, fire ext, first aid kit, life jackets, boat hook
Spotlight with remote
Swim platform rails
VHF radio, DSC capable
 Window defrosters

Construction

Bonded electrical system
 Foam-filled fiberglass stringer grid system
Premium hull color, Midnight Blue
 Self bailing cockpit
 Stainless steel cleats, rails, hardware
 Vinylester barrier coat

RANGER TUGS = MORE VALUE

Bolded items: High value features included in the price of the Ranger Tugs R-31 CB. Other manufacturers oftentimes list these features as options with an additional cost.



Ranger Tugs R-31 CB Packages - FACTORY DIRECT PRICING

The Ranger Tugs R-31 CB is sold **fully equipped** and **ready to cruise** with an expansive selection of premium features and outfitted in one of two packages:

Northwest Edition: Most commonly used in colder climates where air conditioning would not be needed or necessary. **Equipped with diesel forced air heater, and downrigger plugs and pads.**

NORTHWEST EDITION, FULLY EQUIPPED FROM:
\$399,937.00*

Luxury Edition: Most commonly used in warmer climates where air conditioning is a must. **Equipped with air conditioning/reverse cycle heating, and diesel generator w/ sound shield.**

LUXURY EDITION, FULLY EQUIPPED FROM:
\$414,937.00*

Additional Factory Options

Aft cockpit sun and sunset shades	\$1,575
Aft steering, second station with electronic controls	\$5,220
Aluminum triple axle trailer, electric/hydraulic brakes, spare tire w/bracket	\$16,490
Bimini top, command bridge, helm seating only	\$3,610
Carpet runner, Teak and Holly, interior	\$650
Cockpit freezer (in lieu of cockpit refrigerator)	\$630
Cockpit ice maker (in lieu of cockpit refrigerator)	\$630
Dinghy, inflatable RIB 290 CSM hypalon with Weaver davits, stand-off & winch	\$6,065
Factory Delivery Experience	\$3,150
Garmin GXM Weather Antenna	\$1,575
Low speed module	\$2,100
Volvo Five Year Extended Coverage	\$3,360
Hull color upgrade (from standard Midnight Blue)	\$7,875

*Options, freight & taxes extra. Prices, specifications, equipment and options may change without notice. Information on this sheet should not be used for navigation. 0821



47 37th st NE
 Auburn, WA, 98002
 Phone: 253-839-5213

www.RangerTugs.com

