



R-23

Specifications

Length overall (motor down)	28' 5" 8.66 m
Length overall (motor up)	29' 8" 9.04 m
Draft (motor down)	30" 0.76 m
Draft (motor up)	19" 0.48 m
Beam	8' 6" 2.59 m
Bridge clearance (mast down)	8' 6" 2.59 m
Height on factory trailer (w/ radar)	11' 6" 3.51 m
Height on factory trailer (no radar)	10' 10" 3.3 m
Length on factory trailer	36' 10.97 m
Fuel capacity	80 US gal 302.8 L
Water capacity	22 US gal 83.3 L
Waste capacity	11 US gal 41.6 L
Weight, dry	6,000 lbs 2,722 kg
Engine	Yamaha F200 outboard



The first thing you will notice when looking at the popular Ranger Tugs R-23 is the dramatic, curved windshield and visor, accompanied by several overhead skylights. There is no shortage of light or visibility onboard the R-23, which incorporates four opening roof hatches, sliding side windows, and an opening glass bulkhead, providing an open and airy feeling inside and out. Opening portlights also allow for a nice cross breeze in the cabin. The R-23 is powered by a 200 HP Yamaha outboard.

The forward cabin on the R-23 has plenty of room for sitting around the teak table, separate sleeping for two or sleeping two together with the filler-cushion. The mid berth is great for kids or storage, and the dinette converts to a sleeper as the third berth. The well-appointed galley on the R-23 is standard with refrigerator/freezer, cooktop, and microwave. The forward head includes a marine toilet with holding tank, shower, sink, and mirror. The Ranger Tugs R-23 comes standard with a Garmin 943xsv GPS chartplotter with sonar and is available with optional xHD radar. VHF to stay in touch, illuminated compass, cabin night light, cockpit and exterior side trail lighting, and our built-in safety trailering lights (brake, turn, and reverse) are all standard equipment making the R-23 ready to cruise. The cockpit on the R-23 is built to fish and ready to entertain with standard rod holders, optional down-rigger pads & outlets, and a folding double seat.

The R-23 is perfect for overnighting or extended cruises. It incorporates many of the same amenities as a larger cruising yacht that until now were not offered on a boat of her size and price point. Whether you are new to boating or a seasoned captain, the R-23 is the perfect boat for your next adventure. Get on the water today in the Ranger Tugs R-23!

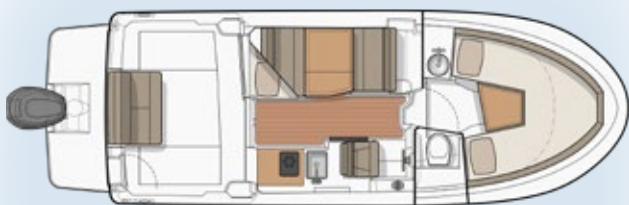

Model Features

Cabin Atrium Skylights and Hatches

The cabin is open and bright, featuring overhead atrium skylights with heat reflective tint and opening rooftop hatches.

Laminar Flow Interrupters

The R-23 is equipped with our Laminar Flow Interrupter technology for smooth, positive cornering performance.

Full Galley

An electric/alcohol stove top, refrigerator/freezer, microwave, hot and cold galley sink, cutting board, and ample storage & counter space makes food prep a breeze.

Multi-use Seating

The aft bulkhead window opens, and the dinette seat transforms to create a rear facing seat. Combined with the L-lounge, the R-23 boasts cockpit seating for 5 adults.

Garmin 943xsv Chartplotter

Navigation is fun and accurate with the Garmin 943xsv Chartplotter with sonar. Easily monitor fuel flow, engine data, bottom conditions, GPS location, tides and much more.

Reliable Yamaha Outboard Power

The R-23 is powered by a Yamaha F200, which delivers outstanding performance and efficiency. A multifunction LCD displays key information such as RPMs and fuel flow. Shift and throttle controls are electronic.

Standard Features

Performance

200 HP Yamaha F200 outboard

Electric trim tabs

Laminar flow interrupters

Bow thruster

Trailerable - 8' 6" beam

Accommodations & Interior Comfort

Atrium skylights

Cabin drink holders, 4

Curtains for privacy

Dinette (seats 4) converts to bed

Fusion stereo system (multi-zone)

Hatches, pilothouse roof, solar reflective, 4

Hatches, stateroom, 2

Indirect cabin lighting

LED lighting

Marine toilet w/ holding tank, pump out

Midship berth

Opening portlights, 2

Private forward stateroom

Shower with enclosure

Storage under mattress

Deck Features

Anchor package, 11 lb, 50' chain, 150' line

EVA foam traction decking

Folding stainless steel mast for trailering

Forward line storage

Bolded items: High value features included in the price of the Ranger Tugs R-23.
Other manufacturers oftentimes list these features as options with an additional cost.

Rod holders, 2

Sport racks, stainless steel

Swimming ladder, stainless steel

Swim step

Windlass, bow and helm controls

Cockpit

Cockpit cover, soft-top

Cockpit drink holders, 2

Cockpit seating, 5+

Opening glass bulkhead w/ reversible seat

Transom entry door for boarding

Helm

Color engine display

Digital fuel flow data

Electronic shift and throttle control, single lever

Garmin 943xsv navigation system w/ GPS and sonar

Helm drink holders, 2

Helm seat, bolstered

USB charging ports

Windshield wipers, 2

Galley

Cutting board

Galley cabinets, 2

Galley drawers, 1

Microwave

Refrigerator/freezer

Sink with hot and cold water, with pull-out rinse faucet

Stove top, electric/alcohol

Mechanical & Electrical

AC electrical panel

Batteries

Battery charger

DC electrical panel

Galvanic isolator

Inverter

Shore power cord(s)

Safety

Carbon monoxide detectors

Courtesy lights

Electric horn

Illuminated compass

Integrated trailer lights

Navigation lights

Swim platform rails

VHF radio, DSC capable

Window defrosters

Construction

Bonded electrical system

Foam-filled fiberglass stringer grid system

Premium hull color, Midnight Blue

Seawater strainer(s)

Self bailing cockpit

Stainless steel cleats, rails, hardware

Vinylester barrier coat

Additional Factory Options

- Aft cockpit sun and sunset shades
- Air conditioning w/ reverse cycle heat (dockside)
- Autopilot, Garmin w/ remote
- Auxiliary motor bracket
- Auxiliary Motor Package: 9.9 HP, electric steering with wireless remote
- Diesel heater, forced air furnace
- Downrigger plugs and pads
- Factory Delivery Experience
- Garmin, xHD radar
- Hull color upgrade (from standard Midnight Blue)
- Lithium ion battery upgrade for air conditioning (requires dockside air conditioning)
- Macerator discharge
- Safety kit: Fenders, lines, flares, fire ext, first aid kit, life jackets, boat hook
- Solar panel, 160 watt, w/ 20amp controller
- Underwater lights

Scan Code for Pricing and Specifications



Options, freight & taxes extra.
Prices, specifications, equipment, and options may change without notice. Information on this sheet should not be used for navigation. ⁰²²²



47 37th st NE
Auburn, WA, 98002
253-839-5213
www.RangerTugs.com

